



PRODUCTS IN THE MEDICAL FIELD FOCUSED ON ERGONOMICS

Just think, if the things you use every day could be adapted to your needs. Just think, if they were designed to match your height and way you work. Just think, you would be able to get everything done faster and more easily. You would not have to work in uncomfortable and potentially harmful positions.

This is how we think at Rini. And this is exactly how we design and build our ergonomic products.



Product catalog 2018 issue 2



Table Of Contents	Side
1. Operating tables microsurgery - RiEye	3
2. Operators chairs microsurgery - Carl	7
3. Special chairs	9
4. Saddle chairs	11
5. Instrument tables operating theatres - Anna	13
6. Device tables for eye examination & treatment - Linnea	18
7. Patient chairs for examination & treatment - Malin and Cecilia	14
8. Armrests for surgery and examination - Rilis and Quick Tight	16
9. Other produkter	18
10. General Terms and Conditions	19

Welcome to Rini!

We are a Swedish company with innovative research and development and have since mid 1990 been a quality supplier of ergonomic products and solutions to medical professionals. We have our own sales and support organization in Sweden and work mainly with appointed distributors on our export markets.

Our business strategy is simple!

Rini offers ergonomic products and solutions uniquely tailored to different treatment areas. Giving doctors and associated personnel a maximum comfortable and productive work environment.

The close contact we have with many highly qualified users is exciting and a positive challenge to continue to develop our products further - always with customer satisfaction in focus!



Rini is a quality certified supplier according to ISO 9001.

Contact us by phone +46 8 594 77170 or E-mail info@rini.se and we will tell you more!

1. Operating table for microsurgery

Operating table RiEye Mk2S

- High quality operating table for optimum work environment and patient safety in microsurgery
- Developed in close collaborations with leading clinics that have strong request on simplicity in use and ergonomics
- Include smart innovations and improvements that have resulted in unique performance in many areas
- Several areas of use with focus on surgical procedures around the patients head

RiEye Mk2S with modern attractive design is developed functionally and ergonomically in close collaboration with a number of leading Swedish and international clinics. The table has wide area of application in both stationary mode or in mobile "roll-in roll-out" procedures.

Great care has been put in the design of the table and its accessories to improve the freedom of movement for the surgeon and assisting personnel in the vicinity of the patients head. The patented weightless headrest is comfortable for the patient and its unique ergonomic design reduces patient pre-op preparation time considerably. Thanks to smooth surfaces and smart seams as well as cushion that are easy to remove, the table is easy to keep clean and hygienic.

The table has a new type of wheel suspension and stands steady even on uneven floors due to the unique adaptive chassis. An ergonomic placed central break locks all four wheels simultaneous in operating mode. If moved it can also move sideways thanks to wheels that easily rotate.

The hand control has an intuitive layout with easy choices in function where back- leg- and seat cushion as well as height can be set individually. Special quick buttons are available for Trendelenburg and zero level positions as well as possibility to pre-program six user settings.

RiEye Mk2S and Mk2 are available in three different models R5, R6 and R7. All models have an unique lowest seat level below 500 mm and a highest seat level at 900mm. All models have cushion kits in different colors, materials and in two different widths, 580 mm or extra wide 700 mm.

Model R5 is designed for narrow spaces, due to the leg rest vertical position when the table is set to its sitting position. This makes it also very easy for the patient to access and sit down from the front of the table. The leg rest is 400 mm long and shaped to fit between the front wheels.

Model R6 gives more comfort for the patient in lying position with its 500 mm long leg rest.

Model R7 with its 680 mm long leg rest suites very well time time-consuming surgery and Anastasia surgery.

There are a number of accessories for example a joystick foot control for fine tuning, electrical head rest, width and length extension cushions, cover bow with or without air and gates. And there are also different accessory kits available. For more information, see separate accessories brochure.

Product code	Description
100-00105-05	New RiEye Mk2S Operating table – R5 <ul style="list-style-type: none"> • Hand control with battery capacity bar • Smooth and easy for the patient to sit down from the front of the table • Leg cushion 400mm long



100-00105-06	New RiEye Mk2S Operating table – R6 <ul style="list-style-type: none"> • Headrest with an unique ergonomic design • Possible to set the backrest 90° inrelation to the seat • Leg cushion 500mm long
--------------	--



100-00105-07	New RiEye Mk2S Operating table – R7 <ul style="list-style-type: none"> • All tables has the unique adaptive chassis • Can be moved sideways • Extra long leg cushion 680mm
--------------	--



Colors selection for standard cushion kits

Product code	Description	R5	R6	R7
140-00202-xx	Cushion kit blue	-00	-01	-02
140-00203-xx	Cushion kit green	-00	-01	-02
140-00204-xx	Cushion kit black	-00	-01	-02
140-00205-xx	Cushion kit grey	-00	-01	-02
140-00308-xx	Cushion kit yellow	-00	-01	-02
140-00310-xx	Cushion kit red	-00	-01	-02
140-00285-xx	Extra wide cushion kit black	-00	-01	-02
140-00210-00	Special color other than standard			

Cushion kits ESD with seamless design in slow recovery material

Product code	Description	R5	R6	R7
140-00222-xx	Cushion kit black ESD	-00	-01	-02
140-00228-00	Special color other than standard			

Accessories for operating table RiEye Mk2S

Accessories marked with * must be factory mounted

Product code	Description
140-00229-01	New Electrical headrest *
140-00270-00	Headrest tray for soft pillow, replaces standard headrest
140-00270-01	Pillow soft, for headrest tray
140-00255-00	Headrest tray for "Reubens pillow", replaces standard headrest
140-00255-01	Reubens pillow soft, for headrest tray
140-00230-01	Foot control with two joysticks
140-00261-01	New Auto access to memory location
140-00266-01	New Electrical brake and direction control*
140-00163-00	Anaesthesia armrest, clamp and arm strap included
140-00231-00	Width extension back rest right 480mm
140-00231-01	Width extension back rest left 480mm
140-00307-00	Width extension back rest right 410mm
140-00307-01	Width extension back rest left 410mm
140-00232-00	Length extension back rest 120mm
140-00242-01	Wrist support standard headrest, bow which can be put down
140-00242-02	Wrist support headrest tray, bow which can be put down
140-00254-00	Driving handles backrest fixed R/L
140-00259-00	Driving handle backrest foldable R/L
140-00256-00	Driving handle leg foldable R/L
140-00235-00	Attachment rail for accessories R or L 250mm
140-00235-01	Attachment rail for accessories R or L 250mm if Side rail is mounted
140-00236-00	Drape support
140-00236-01	Drape support, formable with air tube connection
140-00237-02	New Extra battery
140-00238-01	New Holder for hand control unit rotatable, bracket included
140-00238-02	New Holder for hand control unit fixed, bracket included
140-00238-03	New Holder for hand control unit fixed for IV pole, bracket included
140-00239-01	New IV pole, bracket included
140-00240-00	Side rail collapsible right side
140-00240-01	Side rail collapsible, left side
140-00240-02	New Side rail right or left side 600mm
140-00251-00	Leg cushion cover R6 R7
140-00251-01	Leg cushion cover R5
140-00251-02	Leg cushion cover R6 R7 for slow recovery
140-00263-00	Belt waist
140-00263-01	Belt arm 700mm
140-00263-02	Belt leg 2100mm
140-00265-00	Leg support circular 150mm
140-00265-01	Leg support half circular 200mm

Operating table RiEye Mk1

- Unique availability for surgeon and assisting personnel
- Perfect for both stationary and "roll-in roll-out" operations
- Secure and high patient comfort
- Many accessories

Rinis operating table RiEye has a wide range of applications and can be used stationary in the operating theatre as well as in mobile "roll-in roll-out" procedures.

The design of the table allows great freedom of movement for the surgeon and assisting personnel, particularly in the vicinity of the patient's head. This makes the table perfect for eye surgery, but it can also be used for ear-nose-neck and dental surgery.

For assisting personnel RiEye is easy to manoeuvre thanks to large highly mobile wheels. A centrally controlled brake locks all four wheels at the same time when in operating mode. RiEye is battery powered and can smoothly be adjusted from a sitting to laying position using either a hand or foot control. Customised positions can also easily be programmed.

RiEye has a very stable mechanical design and is equipped with ergonomic cushions which ensure that patients feel secure and comfortable. The table can easily be set to the Trendelenburg position.

There are a number of accessories such as arm support, cover bow with or without air supply, gates, foot support and extra long leg rest. The foot control for precision adjustments during operations works like a joystick and is available either affixed to the table or to be placed on the floor. For anaesthetists there are arm support and drip holders. There are also special versions of RiEye designed for heavy patients and children.

Operating tables

Product code	Description
100-00101-00	RiEye Operating table - standard <ul style="list-style-type: none"> • Very stable manage patient weights up to 200Kg/418lbs • Mobile, large low friction castors 150 mm • Steady on wide wheels plus central brake • Trendelenburg position • Battery input, battery loaded in external charger • Possible to preprogramme positions • Width of seat cushion 600 mm
100-00101-01	Operating table - XL <ul style="list-style-type: none"> • Adjusted for large patients up to 250Kg/550lbs • Mobile, large low friction castors 150 mm • Steady on wide wheels plus central brake • Trendelenburg position • Battery input, battery loaded in external charger • Possible to preprogramme positions • Width of seat cushion 700 mm, 100mm more than standard



Colours of cushions (state when ordered)

140-00153-00	Cushion kit blue for table 100-00101-00
140-00153-01	Cushion kit grey for table 100-00101-00
140-00153-02	Cushion kit green for table 100-00101-00
140-00153-03	Cushion kit black for table 100-00101-00
140-00154-00	Cushion kit blue for table 100-00101-01
140-00154-01	Cushion kit grey for table 100-00101-01
140-00154-02	Cushion kit green for table 100-00101-01
140-00154-03	Cushion kit black for table 100-00101-01

Accessories for operating table RiEye

Product code	Description
140-00168-00	Foot control fixed joystick
140-00169-00	Foot control movable joystick
140-00163-00	Anaesthesia armrest, clamp and arm strap included
140-00170-00	Armrest left side, blue
140-00170-01	Armrest left side, grey
140-00170-02	Armrest left side, green
140-00170-03	Armrest left side, black
140-00171-00	Armrest right side, blue
140-00171-01	Armrest right side, grey
140-00171-02	Armrest right side, green
140-00171-03	Armrest right side, black
140-00190-00	Wrist support, bow which can be put down
140-00191-00	Driving handle, easy to move recumbent patients
140-00160-00	Attachment rail for accessories 250mm
140-00178-00	Drape support
140-00178-01	Drape support, formable with air tube connection
140-00237-00	Battery extra
140-00173-00	Foot support
140-00174-00	Head support, soft
140-00273-00	Headrest kit upgrade Mk1 with the RiEye Mk2S standard
140-00175-00	Holder for hand control unit, clamp included
140-00161-00	IV pole, clamp included
140-00176-00	Side rail collapsible, left side
140-00176-01	Side rail, right side, attachment rail included 140-00160-00
Excellent for anaesthetic surgery	
140-00119-00	Cushion feet support, blue 180 mm extended
140-00119-01	Cushion feet support, grey 180 mm extended
140-00119-02	Cushion feet support, green 180 mm extended
140-00119-03	Cushion feet support, black 180 mm extended

2. Operators chairs for microsurgery

Operator Chairs Carl Mk2, a new generation of electrically controlled chairs for microsurgery

- A uniquely designed frame with three wheels, giving room for the operator's feet and equipment pedals
- Ergonomic comfort for the surgeon through an intuitive setup and the patented safety armrest "Rilis"
- Convenient to move thanks to easy-rolling wheels and a stable parking position by an electric central brake
- Easy to clean with smooth surfaces and encapsulated details

Carl Mk2 is the second generation of Rini's popular electrically adjustable operator chairs where lots of user feedback and new technologies have been combined. The goal has been to provide a quality chair with a small foot print, maximising the area around the feet often where pedals and other equipment are placed.

At the same time for the surgeon, Carl Mk2 offers high ergonomic comfort by extensive selection of armrests to match the clinic requirements. R5 "Easy" is stable and suits many procedures. R6 is supplied with Rini's patented safety armrest "Rilis" that can be adjusted with high precision. R7 "OneGrip" armrest are popular when small adjustments are required. R8 is equipped with "FlexiDoc" armrest for the most demanding procedures.

The chair is battery operated and easy to raise and lower using buttons on the side. The single button control central brake provides a very stable operating position. A cover is supplied to protect the wheels frame. Overall, Carl Mk2 gives the surgeon a tailor-made work environment of the highest quality.

Product code 120-00133-03	Description New Carl Mk2 R6 - Easy arm support <ul style="list-style-type: none"> • Uniquely designed frame with three wheels for high availability • Electric controlled central brake • Seat height from 490 to 800mm • Battery-operated, charger is connected to chair • Back and seat can be adjusted in height and angle • The chair is equipped with Easy arm support
Product code 120-00133-00	Description Carl Mk2 R6 - Rilis arm support <ul style="list-style-type: none"> • Uniquely designed frame with three wheels for high availability • Electric controlled central brake • Seat height from 490 to 800mm • Battery-operated, charger is connected to chair • Back and seat can be adjusted in height and angle • The chair is equipped with Rilis safety arm support
Product code 120-00133-01	Description Carl Mk2 R7 - One hand grip support <ul style="list-style-type: none"> • Uniquely designed frame with three wheels for high availability • Electric controlled central brake • Seat height from 490 to 800mm • Battery-operated, charger is connected to chair • Back and seat can be adjusted in height and angle • The chair is equipped with one hand grip support
Product code 120-00133-02	Description New Carl Mk2 R8 - FlexiDoc <ul style="list-style-type: none"> • Uniquely designed frame with three wheels for high availability • Electric controlled central brake • Seat height from 490 to 800mm • Battery-operated, charger is connected to chair • Back and seat can be adjusted in height and angle • With RoboDoc armrests for the most demanding procedures



Upholstery and colour (state when ordered)

Vinyl has an airy, ventilated slick texture and is not so hot, good for long sessions
Artificial leather has a denser structure and are easier to clean

Product code	Description	Blue	Green	Black
140-00118-xx	Cushion kit vinyl	-00	-01	-02
140-00247-xx	Cushion kit art leather	-00	-01	-02
140-00306-xx	Cushion kit soft padding	Not offered	Not offered	-02

Operators chairs Carl - for microsurgery

- High ergonomic comfort for the surgeon
- Highly adjustable and easily operated
- Equipped with Rini's unique safety arm rests "Rilis"
- Stable design ensures a safe workplace

Rini's operators chairs in the series "Carl" are ergonomically designed and are highly adjustable for back, seating and arms. The chairs are also easy to raise and lower with the feet, which all together gives the surgeon a tailor-made workplace of high quality.

All models are delivered with Rini's unique safety armrest "Rilis" that can be adjusted with high precision to wanted position. For safety reasons, adjustments require two-handed movement to adjust height and angle. The armrest board is able to pivot and slide. The armrest can handle heavy loads.

The load angle of the back support is self-adjusting. The angle of the seat and back support can be simultaneously adjusted with one easy movement. The models "Carl Spring", "Foot" and "Heel" have big low friction wheels, protection cover and central brake.

The operating chairs have been customised for microsurgery and were developed in co-operation with surgeons in Sweden and abroad to achieve the best and highest possible functionality.

The stable base construction in Rini's operating chairs ensures a safe workplace for many years.

Product code	Description
120-00102-00	Carl Foot - foot controlled electrical
120-00102-01	Carl Heel - heel controlled electrical
	<ul style="list-style-type: none"> • Low friction, large 100mm castors • Seat height from 500 to 800mm • Battery-operated, charger is connected to chair • Back and seat can be adjusted in height and angle • The chair is equipped with Rilis safety armrest • Foot controlled brake, brakes at both rear wheels
120-00100-00	Carl Spring - foot controlled with H-chassis
	<ul style="list-style-type: none"> • Low friction, large 100mm castors • Foot controlled height adjustment with ring • Back and seat can be adjusted in height and angle • The chair is equipped with Rilis safety armrest • Foot controlled brake, brakes at both rear wheels
120-00101-00	Carl Swing - foot controlled and rotatable
	<ul style="list-style-type: none"> • Foot controlled height adjustment with ring • An easily moved and rotatable chair • Back and seat can be adjusted in height and angle • The chair is equipped with Rilis safety armrest



Upholstery and colour (state when ordered)

Vinyl has an airy, ventilated slick texture and is not so hot, good for long sessions

Artificial leather has a denser structure and are easier to clean

Product code	Description	Blue	Green	Black
140-00118-xx	Cushion kit vinyl	-00	-01	-02
140-00247-xx	Cushion kit art leather	-00	-01	-02

ESD castors

Product code	Description
140-00243-00	ESD castors - set

Feel free to ask for other types of cushion kits or colours

3. Special chairs for operators and assistants

- Wide range of chairs for operation and examination rooms
- Unique possibilities to customize chairs for optimal function and ergonomic
- All chairs can be equipped with Rini's safety armrest "Rilis"
- Quality chairs for a safe workplace

Rini's ergonomic surgeons and assistant chairs correspond to the high demands put by professionals in operation and examination room environment.

Chairs for operation have as standard foot controlled height adjustment and can be tailor-made when it comes to types of wheels, height of gas spring, different armrests, et cetera.

The chairs can be ordered in different colours and material, please see below.

Product code

120-00115-01

120-00115-00

Description

ComfortMove - foot controlled

ComfortMove - hand controlled

Ideal for long seatings, popular among anaesthetists

Thick and comfortable padding

Tilttable seat

Standard castors

Castors 50mm low friction

Gas spring

Low

Medium

High

Max seat height, mm

710

860

980

Min seat height, mm

560

670

720

120-00105-01

120-00105-00

RiFlex - foot controlled

RiFlex - hand controlled

Adjustable lower back support

Popular Assistant chair for eye or ear surgery

Excellent for those who wants a high seat position

Standard castors

Castors 50mm low friction

Gas spring

Low

Medium

High

Max seat height, mm

680

830

950

Min seat height, mm

530

640

690

120-00104-01

120-00104-00

Dynamic - foot controlled

Dynamic - hand controlled

Chair with unique dynamic lower back support

Popular operator chair within dental care

Thick and comfortable padding

Standard castors

Castors 50mm low friction

Gas spring

Low

Medium

High

Max seat height, mm

730

870

1010

Min seat height, mm

580

690

740

120-00111-01

120-00111-00

120-00111-03

120-00111-02

RiRest - foot controlled

RiRest - hand controlled

RiRest - backrest foot controlled

RiRest - backrest hand controlled

Soft seat small and movable

Popular within operating theaters

Easy to maintain clean

Standard castors

Castors 50mm high friction

Gas spring

Low

Medium

High

Max seat height, mm

570

690

820

Min seat height, mm

430

500

580



120-00111-01

120-00111-02

Upholstery

Product code	Description	Stamskin	Art leather	Leather	Vinyl
	ComfortMove	Option	Std	Option	Option
	CorrectSit	Std	Option	Option	Option
	RiFlex	-	-	-	Std
	Dynamic	Std	Option	Option	Option
	RiRest	-	-	-	Std

Colour

Product code	Description	Blue	Green	Black	Other colour
	ComfortMove	Option	Option	Std	Option
	CorrectSit	Option	Option	std	Option
140-00245-xx	RiFlex	-00	-01	-02	-
	Dynamic	Option	Option	Std	Option
140-00246-xx	RiRest	-00	-01	-02	-

Choice of castors

Product code	Description
140-00122-00	Castors 50mm low friction - set
140-00122-01	Castors 50mm high friction - set
140-00122-04	Castors 65mm low friction - set
140-00123-00	Trumpet glider

Choice of gas spring

Product code	Description
140-00124-00	Gas spring low
140-00124-01	Gas spring medium
140-00124-02	Gas spring high

Accessories

Product code	Description
140-00183-00	Foot support foot controlled chairs
140-00182-00	Foot support hand controlled chairs

4. Saddle chairs for operators and assistants

- Wide range of designs saddle chairs to match individual needs
- Foot adjustment for operating environments
- All chairs can be equipped with Rini's unique safety armrest "Rilis"
- Stable design providing a safe workplace

Sit correct and feel much better! More and more chooses saddle chairs to avoid back and shoulder related problems. Our wide range of saddle chairs guarantees that you find the one that suite you best.

By using the saddle chairs correctly, a balanced correct seating is achieved thanks to the shape of the seat and an open hip angle. The chairs are available in different colours and material; leather, leatherette, PVC fabric and fabric.

Product code	Description
120-00106-01	Amazone - saddle chair foot controlled
120-00106-00	Amazone - saddle chair hand controlled
120-00106-02	Amazone - back support hand controlled
120-00106-03	Amazone - back support foot controlled
120-00106-04	AmazoneBalance - hand controlled
120-00106-05	AmazoneBalance - foot controlled
	<ul style="list-style-type: none"> • For you who find other saddle chairs too wide • Thick and comfortable padding and tiltable seat • Excellent for you who want a high seat position

Standard castors

Castors 65mm break unloaded

Gas spring	Low	Medium	High
Max seat height, mm	710	860	980
Min seat height, mm	560	670	720



120-00110-01	Jumper - saddle chair foot controlled
120-00110-00	Jumper - saddle chair hand controlled
120-00106-02	Jumper - back support hand controlled
120-00106-03	Jumper - back support foot controlled
120-00106-04	JumperBalance - hand controlled
120-00106-05	JumperBalance - foot controlled
	<ul style="list-style-type: none"> • A chair for longer sittings • Excellent for you who wants a lower seat position • Thick and comfortable padding and tiltable seat

Standard castors

Castors 65mm break unloaded

Gas spring	Low	Medium	High
Max seat height, mm	710	860	980
Min seat height, mm	560	670	720

120-00107-01	Perfect classic - saddle chair foot controlled
120-00107-00	Perfect classic - saddle chair hand controlled
	<ul style="list-style-type: none"> • Easy to maintain clean due to a seamless design • Thick, more compact padding • Tiltable seat

Standard castors

Castors 50mm low friction

Gas spring	Low	Medium	High
Max seat height, mm	650	770	910
Min seat height, mm	540	580	650



120-00123-01	Perfect lite - saddle chair foot controlled
120-00123-00	Perfect lite - saddle chair hand controlled
	<ul style="list-style-type: none"> • Easy to maintain clean due to a seamless upholstery • A small chair, excellent for them who want a high seat position • Tiltable seat

Standard castors

Castors 50mm low friction

Gas spring	Low	Medium	High
Max seat height, mm	650	770	910
Min seat height, mm	540	580	650

Upholstery

Product code	Name	Stamskin	Art leather	Leather
	Amazona	Option	Std	Option
	Jumper	Option	Std	Option
	Perfect classic	Option	Option	Std
	Perfect lite	Option	Option	Spec

Colour

Product code	Name	Black	Other colour
	Amazona	Std	Kundval
	Jumper	Std	Kundval
	Perfect classic	Std	Kundval
	Perfect lite	Std	Kundval

Choice of castors

Product code	Description
140-00122-00	Castors 50mm low friction - set
140-00122-01	Castors 50mm high friction - set
140-00122-04	Castors 65mm low friction - set
140-00123-00	Trumpet glider

Choice of gas spring

Product code	Description
140-00124-00	Gas spring low
140-00124-01	Gas spring medium
140-00124-02	Gas spring high

Accessories

Product code	Description
140-00183-00	Foot support foot controlled chairs
140-00182-00	Foot support hand controlled chairs

5. Instrument table for operating theatres

Instrument table Anna - for operating theatres

- Flexible stainless steel tables of high quality in several unique designs
- Sound absorbing table top, easy to clean
- Electrical maneuvered with one single button, large height span
- Steady also on uneven floors

The instrument table called "Anna" are of highest quality and are available in several standard designs but can also be tailor made. The table tops are sound absorbing and are provided with drip pan. The wheelbase is manufactured in stainless steel for easy cleaning.

Anna Tripod has a flat lifting column assemble at the short side of the table which allows great accessibility over operating table. The wheelbase with three wheels makes the table steady even on uneven floors and the location of the large wheels and their brake function makes the table extra steady. The height control can be placed where it gives optimal accessibility.

Anna Cross was developed in co-operation with operating personnel with need of a larger instrument table with high lifting capacity and good accessibility. The wheelbase consists of round, stainless steel pipes with four easily rolled, ball bearing and lockable wheels. The design of the base gives plenty of space for feet and chairs. The table-top has also a stainless steel underneath for easy cleaning.

All of Rinis instrument tables fulfil the highly set demands in challenging operating theatres.

Product code	Description
130-00105-00	Anna Tripod - instrument table with three wheels <ul style="list-style-type: none"> • Height adjustment from 700 to 1100mm • Size of table top 700x500mm • Individually braking castors, low friction • Battery powered, charger connect to table • Sound absorbing table top
130-00106-00	Anna Cross - instrument table with four wheels <ul style="list-style-type: none"> • Height adjustment from 850 to 1350mm • Size of table top 1140x600 mm • Very stable, can manage up to 75Kg • Battery powered, charger connect to table • Sound absorbing table top
130-00106-01	Anna Cross - instrument table with fall edges and four wheels <ul style="list-style-type: none"> • Fall edges so the Medical-guidewire for Endoscopic procedures remains on the table • Fall edges designed to prevent bacterial collections • Size of table top 1000x600 mm • Very stable, can manage up to 75Kg • Battery powered, charger connect to table



Instrument table variants:

140-00149-00	Height adjustment 850-1350mm table 130-00105-00
140-00151-00	Table top size 600x400mm table 130-00105-00
140-00152-00	Table top size 1300x500mm table 130-00106-00

Contact us if you have a request of other sizes of table tops

6. Device table, instrument ophthalmology

Device table Linnea

- Unique accessibility for personnel and patients, especially for wheelchair dependent patients
- Several standard table top sizes, as well as tailor-made
- Electrically controlled in height, very stable and handles high weights
- Is a part of Rinis ergonomic concept for an effective and elegant health care environment

Rinis device tables are developed to provide extra good accessibility for operators and patients, especially wheelchair dependent patients. The tables are available in several standard sizes but can also be adapted to unique examination environments. All tables have soft-start, stop and are equipped with safety stop for the patient.

The tables are ideally suited for eye-examination rooms, were for example slit lamps, lasers, microscopes and similar equipment are being assembled on them. The Linnea-tables with their special lifting columns are very stable and weight durable. The tables are easy to manoeuvre on four ball bearing wheels with brakes.

Linnea Rifo is the product name of our larger, tailor-made device tables. Design your own table top, state the dimensions of your design and we will build it.

The tables are a part of Rinis ergonomic concept for an elegant, easy-to-use and cost effective practice; device tables, patient chairs and operator chairs.

Product code	Description
130-00102-00	Linnea 650 - device table <ul style="list-style-type: none"> • Width between columns 650mm • Table top of beech laminate, size 800x350x22mm • Electrically adjustable height from 690 to 1040mm • Manage weight up to 130Kg • Connected to 230 V • Equipped with safety brake for the patient
130-00103-00	Linnea 850 - device table <ul style="list-style-type: none"> • Width between columns 850mm • Table top of beech laminate, size 1000x420x22mm • Electrically adjustable height from 690 to 1040mm • Manage weight up to 130Kg • Connected to 230 V • Equipped with safety brake for the patient
130-00104-00	Linnea 1050 - device table <ul style="list-style-type: none"> • Width between columns 1050mm • Table top of light grey laminate, size 1180x350x22mm • Electrically adjustable height from 690 to 1040mm • Manage weight up to 130Kg • Connected to 230 V • Equipped with safety brake for the patient
130-00107-00	Linnea Rifo - device table, <ul style="list-style-type: none"> • Design your own device table • Table top of beech laminate, according to your design • Electrically adjustable height from 690 to 1040mm • Manage weight up to 130Kg • Connected to 230 V • Equipped with safety brake for the patient
130-00109-00	Linnea Piccolo - device table, <ul style="list-style-type: none"> • Width between columns 720mm • Table top of light grey laminate, size 870x365/420x22mm • Electrically adjustable height from 580 to 1240mm • Manage weight up to 80Kg • Connected to 230 V • Equipped with low wheel base and two sockets 230V outlets as standard



approx. price



Device table 130-00102-00 table top variant:

Product code	Description
140-00140-00	Table top of beech laminate, 800x450x22mm
140-00141-00	Table top of beech laminate, 1000x420x22mm, asymmetric

Device table 130-00103-00 table top variant:

Product code	Description
140-00142-00	Table top of beech laminate 1000x350x22mm
140-00143-00	Table top of beech laminate 1000x500x22mm
140-00144-00	Table top of beech laminate 1180x350x22mm, asymmetric
140-00145-00	Table top of grey laminat with birch edge 1000x450x38mm

Device table 130-00104-00 table top variant:

Product code	Description
140-00146-00	Table top of light grey laminate, size 1180x420x22mm

Device table 130-00109-00 table top variant:

Product code	Description
140-00150-00	Table top of light grey laminate, size 870x420x22mm
140-00145-03	New Table top of grey laminat with birch edge 1000x420x38mm cut out for H-S chin support

Options:

	Description
140-00139-00	Low wheel base, table lowered with 75mm
140-00121-00	Control box mountet to column for more space beneath table top
140-00248-00	Factory mounted power outlet under table top

Accessories:

Product code	Description
140-00272-00	Chin support bracket H-S 18mm
140-00272-01	Chin support bracket H-S 60mm

Do not hesitate to ask for other sizes of table tops and designs

7. Patient chairs for examination and treatment

Patient chairs Malin - electric

- Easy rolling chairs that can handle heavy loads and have many flexible accessories
- Central brake with extra large rubber wheels that makes the chair very stable in brake mode
- Electrical control with a wide height adjustment to fit various types of examinations and treatments
- Stable design that provides safety for patient as well as personnel

Rinis battery powered patient chairs in the series "Malin" are ergonomically designed and can handle heavy patients. The height adjustment between 500-800 mm is controlled by a fixed or wireless hand control.

The chair is equipped with central brake, shaped as a hoop between the rear wheels. The hoop breaks both rear wheels simultaneously and makes the chair almost impossible to move when breaks are locked. While as unbraked the chair is easily rolled and comfortable with the four large wheels.

The chairs have accessories such as foot support, driving handle, wireless hand control, phlebotomy armrest.

There is an extra high version of "Malin" with seat height from 540 mm up to 940 mm for ophthalmologists, to optimize the ergonomic work environment during examination and treatment of children.

Product code	Description
120-00103-00	Malin Rock - hand controlled <ul style="list-style-type: none"> • Low friction large 100mm castors with double ball bearing wheels • Lifting capacity from 500 to 800mm • Battery powered • Stable manage patient weights up to 120Kg
120-00103-01	Malin Swing - hand controlled <ul style="list-style-type: none"> • Seat can be rotated $\pm 90^\circ$ • Low friction large 100mm castors with double ball bearing wheels • Lifting capacity from 500 to 800mm • Battery powered • Stable manage patient weights up to 120Kg
120-00103-02	Malin Slim - hand controlled <ul style="list-style-type: none"> • Wheelbase for narrow floor space under the table • Low friction large 100mm castors with double ball bearing wheels • Lifting capacity from 500 to 800mm • Battery powered • Stable manage patient weights up to 120Kg



Options

Product code	Description
140-00128-00	Extended lifting capacity from 540mm to 940mm
140-00126-00	Wire less hand control infrared 1ch
140-00126-01	New Wire less hand control infrared 2ch (if electrical brake)
140-00133-00	Foot control
140-00250-00	Electrical brake by the standard hand control
140-00315-00	New Wheels with direction control

Accessories

Product code	Description
150-00102-00	Armrest standard left
150-00102-01	Armrest standard right
150-00103-00	Armrest collapsible left
150-00103-01	Armrest collapsible right
150-00105-00	Armrest for fluorescein photography left 350mm
150-00105-01	Armrest for fluorescein photography right 350mm
140-00129-00	Foot support plate of rubber, not for chair 120-00103-02
140-00130-00	Foot support T-shaped of metal, not for chair 120-00103-02
140-00132-00	Driving handle 450mm
140-00132-02	Driving handle 600mm
140-00260-00	Belt for patient
190-0018-00	New Head support



Colours of cushion kit

Product code	Description
140-00135-00	Cushion kit blue
140-00135-01	Cushion kit green
140-00135-02	Cushion kit black

Do not hesitate to ask for other models and colours of cushions

Patient chairs Cecilia

- Ergonomic quality chairs for efficient examination and treatment
- Easy operation to adjust seat and back support
- New and safe phlebotomy armrest "QuickTight"
- Adjustable headrest for ear treatment

The patient chairs called "Cecilia" have adjustable armrests. Height and angle of seat and back support are also adjustable with a simple hand grip.

The Cecilia chairs are available in different designs. When used for examination they are equipped with Rinis new armrest for sampling, QuickTight. They are easy to adjust and lock in desired position, comfortable for both patient and personnel.

Cecilia is as ear examination chair equipped with a headrest which is adjustable in both height and deep.

The chairs are provided with trumpet gliders and dressed in beige PVC fabric. As an alternative to trumpet glider can the chairs be supplied with wheels.

Product code	Description
120-00112-00	Cecilia Test - sampling chair <ul style="list-style-type: none"> • Curved padded armrests with simple adjustment • Lift height from 450 to 590 mm • Upholstery of beige PVC fabric • Manage patient weights up to 120Kg

Product code	Description
120-00113-00	Cecilia Ear - otology chair <ul style="list-style-type: none"> • Adjustable headrest in height and depth • Lift height from 450 to 590 mm • Upholstery of beige PVC fabric • Manage patient weights up to 120Kg



8. Armrests

Safety armrest Rilis for operating theatre and health care

- Unique design for optimal support and pressure relieve
- Highly adjustable, weight durable
- Available on all of Rinis chairs and most dental units
- Available in several models and colours

Rinis patented safety arm rest "Rilis" are very popular within microsurgery but also among dentists and other treating personnel within dental care. The Rilis arm rests are entirely unique and allows high precision adjustment to the position requested for support or to relieve pressure.

By safety reasons requires a two-handed movements to adjust the arm rest. The height and angle of the armrests can be altered with ease and are also pivotal and rotatable. Rilis can handle heavy loads. The arm rests are available in several designs and colours.

Product code	Description
150-00100-00	Rilis armrest <ul style="list-style-type: none"> • The armrest plate is upholstered after request • Unique safety armrest • Adjusted with great precision • Brackets fitting all of Rinis operator and assistants chairs



Brackets

Product code	Description
000-03067-00	Bracket right/left elliptic
000-01130-00	Bracket right/left rectangular 30x15mm
140-00303-00	Bracket right/left ComfortMove special chair

Undercarriages

Product code	Description
000-03577-01	Under carriage saddle chairs elliptic <ul style="list-style-type: none"> • Jumper, Classic, MultiAdjuster, Swing, Perfect classic, Perfect lite
000-03864-01	Under carriage Bambach elliptic
140-00200-00	Under carriage RiFlex Bambach
000-01325-01	Under carriage saddle chairs 30x15mm <ul style="list-style-type: none"> • Amazone, Jumper, Perfect classic, Perfect lite
000-03940-01	Under carriage Dynamic elliptic
000-01674-01	Under carriage CorrectSit 30x15mm



Armrest QuickTight for operation and health care

- Easy to clean by unique design
- Flexible and easy to adjust
- Comfortable ergonomic design
- High quality with minimal maintenance

QuickTight is an ergonomically designed armrest for sampling which is designed to fit both patient and personnel. The comfortable armrest gives an excellent support for the arm and wrist of the patient while taking the sample. It has great movability, and is easily adjusted and locked in requested position by a minimum of effort.

QuickTight is hygienic and easy to maintain clean. The smooth molded cushion is completely seamless and free from dirt collecting creases. The material withstands all ordinary detergents and disinfectants. The arm is completely made out of stainless steel with smooth surfaces which is easily cleaned.

QuickTight is a high quality product, created for long durability. The unique design in resistant materials requires minimal maintenance, which in turn provides good economy.

QuickTight is also available in other designs with such as upholstered armrest. QuickTight fits all of Rinis chairs.

Arm rests

Product code	Description
000-03379-00	Armrest plate in moulded seamless design
000-01327-00	Armrest plate arched
000-03395-00	Armrest plate 270x130mm
000-00431-00	Armrest plate 345x170mm

Arm

Product code	Description
140-00127-00	Arm 75° 400mm, ball joint for curved armrest
140-00180-00	Arm 105° 400mm long

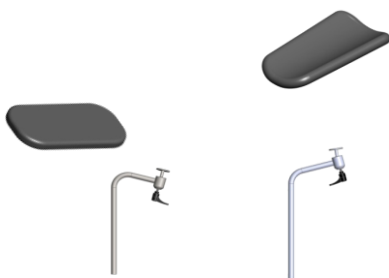

Bracket chair

Product code	Description
000-03374-00	Bracket right elliptic
000-03375-00	Bracket left elliptic
000-03372-00	Bracket right rectangular 30x15mm
000-03373-00	Bracket left rectangular 30x15mm



Safety armrest Rilis for patient chairs dental

- Unique design for optimal support and pressure relieve
- Highly adjustable, weight durable
- Available on all of Rini's chairs and most dental units
- Available in several models and colours

Rini's patented safety arm rest "Rilis" are very popular among dentists and other treating personnel within dental care. The Rilis arm rests are entirely unique and allows high precision adjustment to the position requested for support or to relieve pressure.

By safety reasons, a two-handed movements requires to adjust the arm rest. The height and angle of the armrests can be altered with ease and are also pivotal and rotatable. Rilis can handle heavy loads. The arm rests are available in several designs and colours.

Product code	Description
150-00101-00	Rilis Armrest - for dental unit <ul style="list-style-type: none"> • Unique safety armrest • The armrest plate is upholstered after request • Placement left or right side • Brackets for many different patient chairs



Brackets for dental units

000-03089-00	Bracket flex for dental unit <ul style="list-style-type: none"> • CanCan, Planmeca, HEKA, XO, Stenstrup and more
000-03099-00	Double bracket for KaVo unit
000-06090-00	Bracket for KaVo unit makes the Rilis easy to mount and remove

Brackets can be available for other patient chairs, contact Rini for more information

9. Other ergonomically products

Ladder Lars and platform Fabian

- Improves ergonomics by raising the work position
- Easily moved
- Wheels that lock when loaded
- Easy to maintain clean

These platforms have been designed to improve the ergonomics during examination, treatment and operation. They are easy to move to wanted place. The wheels automatically locks when loaded.

The ladder "Lars" has been developed mainly to make it easier for personnel during examinations and treatment of legs, and when place of patients onto higher bunks and beds. "Lars" is manufactured of varnished steel, rubber coated wheels and anti slip protection. There are three models, with or without handles and "Lars" with 3 steps to suit various needs. "Lars" with 3 steps the wheels must be locked by the personnel.

"Lars" can be ordered with trumpet gliders to replace the wheels.

Product code	Description
160-00102-00	Ladder Lars with handle <ul style="list-style-type: none"> • Height 300mm at highest step • Very stable • Provided with anti-slip protection
160-00102-01	Ladder Lars without handle <ul style="list-style-type: none"> • Height 300mm at highest step • Very stable • Provided with anti-slip protection
160-00102-02	Ladder Lars 3 steps with handle <ul style="list-style-type: none"> • Height 450mm at highest step • Very stable • Provided with anti-slip protection



10. General Terms and Conditions

1. Orders, Prices etc.

All prices are exclusive of VAT and other taxes or official duties. A quotation shall be binding for RINI for thirty (30) days from the date of the offer, unless otherwise stated in writing.

Any information on weight, measurement, capacity etc. in catalogues, prospects, folders are estimates only. All technical data is provided subject to design modifications.

A change of customs, taxes or other official duties, which results in increased cost to RINI, entitles RINI to increase the offered or agreed price.

2. Payment

Orders are to be pre-paid before shipment if not otherwise agreed.

For customers with an established credit line, payment is due strictly thirty (30) days from date of invoice. Any payments not made when due shall accrue interest from the due date until the date payment is made at a per annum rate equal to 18 percentage and will result in that future orders are be prepaid.

3. Transportation and Packing

RINI handle packing and delivery of products according to "INCO TERMS Ex Works" of not otherwise agreed.

If other INCO TERMS are agreed for delivery, transportation, insurance and other handling fees will be charged in accordance with RINI's rates prevailing at the time of delivery. If the customer request express delivery, e.g. express cargo, courier, airfreight, the customer is obliged to compensate RINI for the actual cost of transportation in addition to the normal handling charge.

4. Risk of loss of Product

The risk of the product passes to the customer when RINI has delivered the product according to the agreed INCO TERM. Hence, RINI is only responsible for damage that may occur to the product up to the point in time when the risk passes to the customer.

5. Delivery time

The indicated delivery time starts when all terms in the purchase contract has been fulfilled. In case of pre-paid orders the delivery time starts when RINI has received payment. The product is considered to be delivered when risk of loss and damage passes to the customer in accordance with Section 4.

6. Inspection of Product

When a delivery is received the customer shall inspect the transportation packages and products for any transportation damages. If a transport damage has occurred, before the risk of the product has passed to the customer, the customer shall immediately report this to the shipping company and send a copy to RINI with full details of the damages including digital photo.

7. Warranty

RINI warrants that product sold at the time of the passing of risk as stipulated in Section 4 will be free from faults and shortcomings in construction, material and manufacture for 12 months. If the product is of the type requiring alignment or service, RINI is only responsible for faults remaining after such alignment or service has been carried out.

The customer shall immediately after the discovery of the fault or shortcoming make a claim to RINI in the form of a detailed description of the fault or shortcoming. However, such claim must be presented to RINI no later than 7 days after the day the customer discovered or ought to have discovered the fault or shortcoming.

After the receipt of a claim RINI will, at RINI's option, accept the return of the faulty product and reimburse the customer an amount equal to the purchase price, or repair or replace the faulty product.

RINI's responsibility for faults or shortcomings of delivered products is limited to the above. The customer is not entitled to any other remedies, but the above, in relation to faults or shortcomings.

8. Indirect Damages

The customer is not entitled to, and RINI is not in any event liable to pay, compensation for damages which the delivered product has caused to other property or to persons or any other consequential damages, including but not limited to loss of profit, loss of production or any other indirect damages.

In the event RINI would be held liable for compensation to third party for fault or safety shortcomings under the stipulations of, as it is called, product liability, the customer shall fully indemnify RINI for all damages finally awarded or settlement agreed, including RINI's costs in relation thereto, unless the damages caused by the fault or security shortcoming were due to gross negligence of RINI. RINI will give the customer notice of such claim and make it possible for the customer, if customer so wish, to influence the formulation of RINI's statement of defence or the terms to a possible settlement with the person presenting the claim, provided the customer issues a security, acceptable to RINI, for any costs or damages which can be imposed upon RINI.

9. Retention of Title

Products delivered shall remain the property of RINI until payment in full has been made.

10. Intellectual Property Rights

Customer is obliged to immediately notify RINI of any claim from third party alleging that products delivered under this Agreement infringes intellectual property rights (patent, registered design, trademark or copyright) of a third party. Provided customer present such claim immediately and provided customer grants RINI sole authority to defend or settle the case, RINI undertakes, at RINI expense, to defend the case, or come to a settlement, with the third party whose intellectual property rights has been infringed by the product delivered under this Agreement.

If it is held that a product delivered under this Agreement has infringed third party intellectual property rights RINI shall, at his own expense, and at RINI's option, obtain for the customer the right to continue using the product, replace or modify it so it becomes non-infringing or, in exchange for the return of the product, reimburse the price of the product. RINI is always entitled to deduct and the customer is obliged to pay an amount equal to the use of the product from the time of delivery to the claim was presented. If RINI has modified or developed a new product upon customer instructions or specifications, customer shall fully reimburse RINI for any and all costs and damages that might occur as a result of the modified or new product infringing third party intellectual property rights.

11. Force Majeure

If either party is prevented from performing under this Agreement due to force majeure the other party may not establish any sanctions for this reason. However, if the hindrance regards the customer's possibility to carry out payment RINI is entitled to withhold delivery of the product until payment has been effected. If the hindrance to effect payment last for more than four (4) weeks RINI is entitled to cancel the purchase.

The term "force majeure" means in this Agreement that the performance under the agreement is prevented, aggravated or delayed due to war, rebellion or riot, mobilization or unexpected call for military service of similar dimensions, requisition, seizure, exchange restrictions, export or import restrictions, general scarcity of merchandise, shortage of transportation, labour conflict, restrictions on fuel and power, fire, faulty or delayed deliveries from subcontractors due to above causes, as well as any other circumstance beyond the control of the party.

12. Governing Law and Disputes

This agreement and any disputes hereunder shall be governed by Swedish law.

Any legal action relating to this Agreement and all legal relationships associated with it shall be decided by District Court of Stockholm as exclusive jurisdiction of first instance. However, RINI is entitled to turn to the district court or the Enforcement Service in the county or city where the customer has his legal domicile as regards claim for payment due.

The fact that a dispute has occurred does not exempt the customer to make payment due or to fulfil any other obligations under the agreement.

13. Miscellaneous

Either party's failure to enforce breach of this Agreement or to exercise its rights due to such breach shall not be deemed a waiver of such rights to enforce any future breach of agreement.

What is stated in this document as regards all matters contained is the full and exhaustive description of RINI's responsibilities and the rights of the customer. As regards such matters dealt with the customer is not entitled to any other remedy or compensation.